

# Project Information Holy Cross Church Access Project

Thank you for considering our application for funding please find the details of our application shown below. Please do not hesitate to get in touch should you require more information, or testimonials from our local community.

## Background information about Holy Cross Church



Holy Cross church is an Anglican parish church, in the Diocese of Chichester situated on the main road into Bognor Regis from Chichester. The parish forms the southern edge of what Bognor Regis, the parish of North Bersted. We have a diverse congregation who attend church despite difficulties of access. It is a matter of great disappointment to us that we are not able to welcome everyone, easily and independently into our building.

We have a church hall that is used by a wide range of community groups, from exercise classes, to support groups for dementia carers, to the local AA group. The hall provides a high-quality flexible venue for a reasonable price and as such is in constant regular use. This is great but makes it difficult for the church to

host occasional events or start new projects as without access to the hall: the church is not a useable venue, no access, no toilet, no water.

## What do we need?

We need a fully accessible entrance to the church for people with all disabilities, as well as an accessible toilet that can be available whenever the church building is in use. To create space for the toilet we will have to create some additional storage space in the nave of the church building to replace existing storage in the porch.

We are looking for a grant of £12,000 as part of our campaign to raise £67,000 to match the £50,000 raised by the local congregation to enable us to proceed with commissioning builders to complete the work by the end of January 2024.

## Our church and community



Holy Cross Church is ideally positioned in the centre of our community, we have a diverse church community and work well with the local residents and organisations to provide support for our parish. We have a faithful worshipping community of over 100 with an average weekly attendance at services of about 60.

The local area has mixed demographics with areas of new housing attracting new people to the area alongside areas of extremely low income, putting us in the bottom quartile for deprivation in the

whole country. Over the winter we opened our hall as a 'Warm Welcome space' to do our bit to

help the community with the cost-of-living crisis. We have also been collaborating with our local Parish Council with a new project called 'Food for Bersted families', we are making plans to expand this work in collaboration with other charities, particularly looking at the provision of affordable food outside usual working hours. The completion of the access project will greatly strengthen and support our work in these areas.

## The proposals

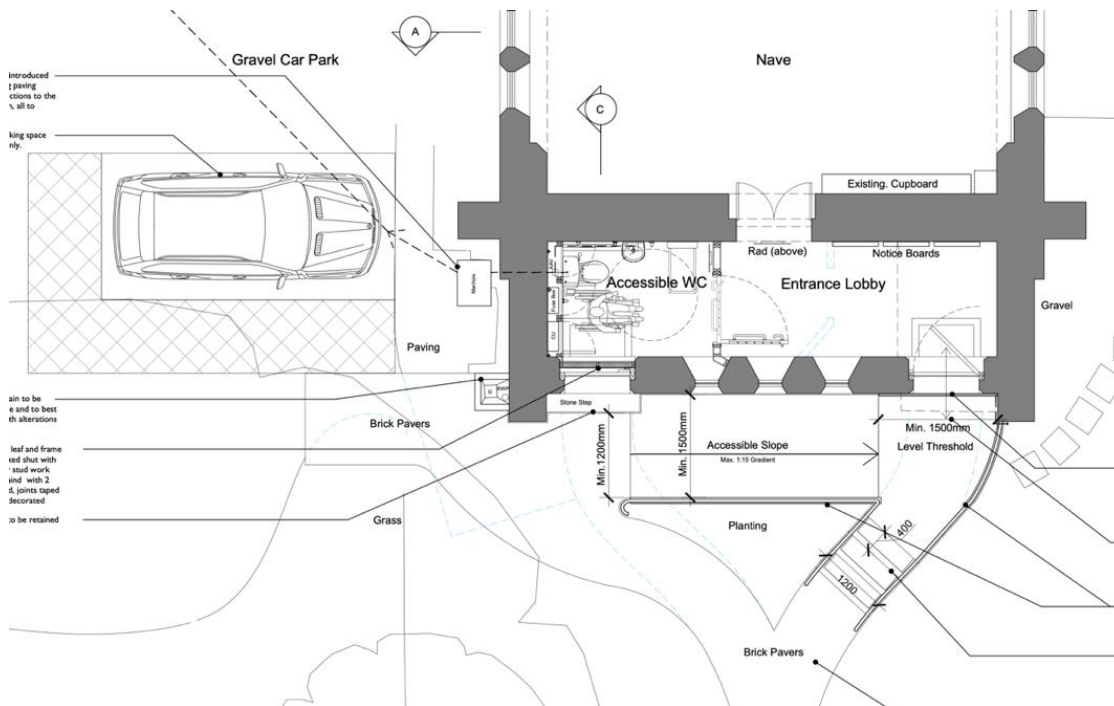

### Accessible entrance

The proposed plan to create a slope from the car park along the front of the church building and create level access through the door on the furthest side of the church, this ramp will comply with current regulations for steepness and will have a handrail fitted. There will also be a set of shallow steps from the platform at the top of the slope allowing entrance to the church from the pavement.

### Toilet facilities

It is proposed that we will use half of the porch space to create the accessible toilet. The entrance to the church nave sits in the middle of the porch area and there is space to create a private area for the toilet, along with a handwashing sink and water tap.

### Replacement Storage

Cupboards would be built in the first alcove on the right-hand side of the church. These cupboards would match existing cupboards on this side. They would be below the height of the windowsill and fit neatly in this gap.

### What difference will this project make?

Once the project is completed, we will have an accessible church that can be used for events and activities, we will be able to extend our welcome to community groups and be able to use our building for a wider range of events and activities. The church already benefits from flexible seating and a good audio/visual system, once the access is done, we will be able to offer a wide range of activities. Projects that will be made easier by the accessible entrance include study groups and short courses

in the church building, offering a range of evening classes and concerts, starting new projects such as an evening food hub to people in our community. For example, last year we received some funding to host community conversations from the Department for Levelling Up; there was enthusiasm to continue those conversations monthly, but we don't have a suitable space available, once the work is done, we will be able to use the church building.

### Project Budget

We have already invested over £12,000 over the last few years from our reserves towards this project, not to mention many hours of valuable volunteer time. We now have all our permissions granted and are in a position to start work as soon as funding is in place.

Please see below a budget for our project, the prices are based on tenders completed a few months ago and prices have been rounded up to allow for inflationary pressures. We are aware that inflation is running at a very high level at the moment making the prices of projects in the future challenging, we have added an inflationary contingency to our budget on top of the contractor's usual contingency.

\*These items relate to the provision of accessible features and are therefore expected to be zero rated for VAT purposes. The church is not a listed building and therefore is liable for usual VAT charges

<b>Costs</b>	<b>Excluding VAT</b>	<b>Including VAT</b>
Building Control Inspection	1340	1608
General site & management costs	10,400	12480
Building Ramp*	37930	37930
Accessible toilet*	35600	35600
Storage Cupboards	8,000	9600
Contingency	8500	10200
Inflation contingency	10,000	12000
	<b>111770</b>	<b>119418</b>

### Fundraising Plan

Now we have all our permissions in place we are looking to complete the fundraising for the project and are applying for a range of grants to complete the project. Details are shown in the relevant part of the application form.

### Completion Dates & Monitoring & Evaluation of the project

We are aiming to have fully funded the project by November 2023 so that we are able to complete the project this year. The build is expected to take approximately 4 weeks and so we plan to have the work completed in time for a glorious celebration at the end of January 2024.

We will know the project is successful when we are able to watch members local community entering and leaving our building safely and easily. We will see an increase in activity in the church outside of Sundays and we will see new people being able to access a range of support services offered.